

**FOCUS**  
MOTOR YACHTS



**3X**



*FOCUS 3X*





*FOCUS 3X*



*FOCUS 3X*





*FOCUS 3X*



*FOCUS 3X*







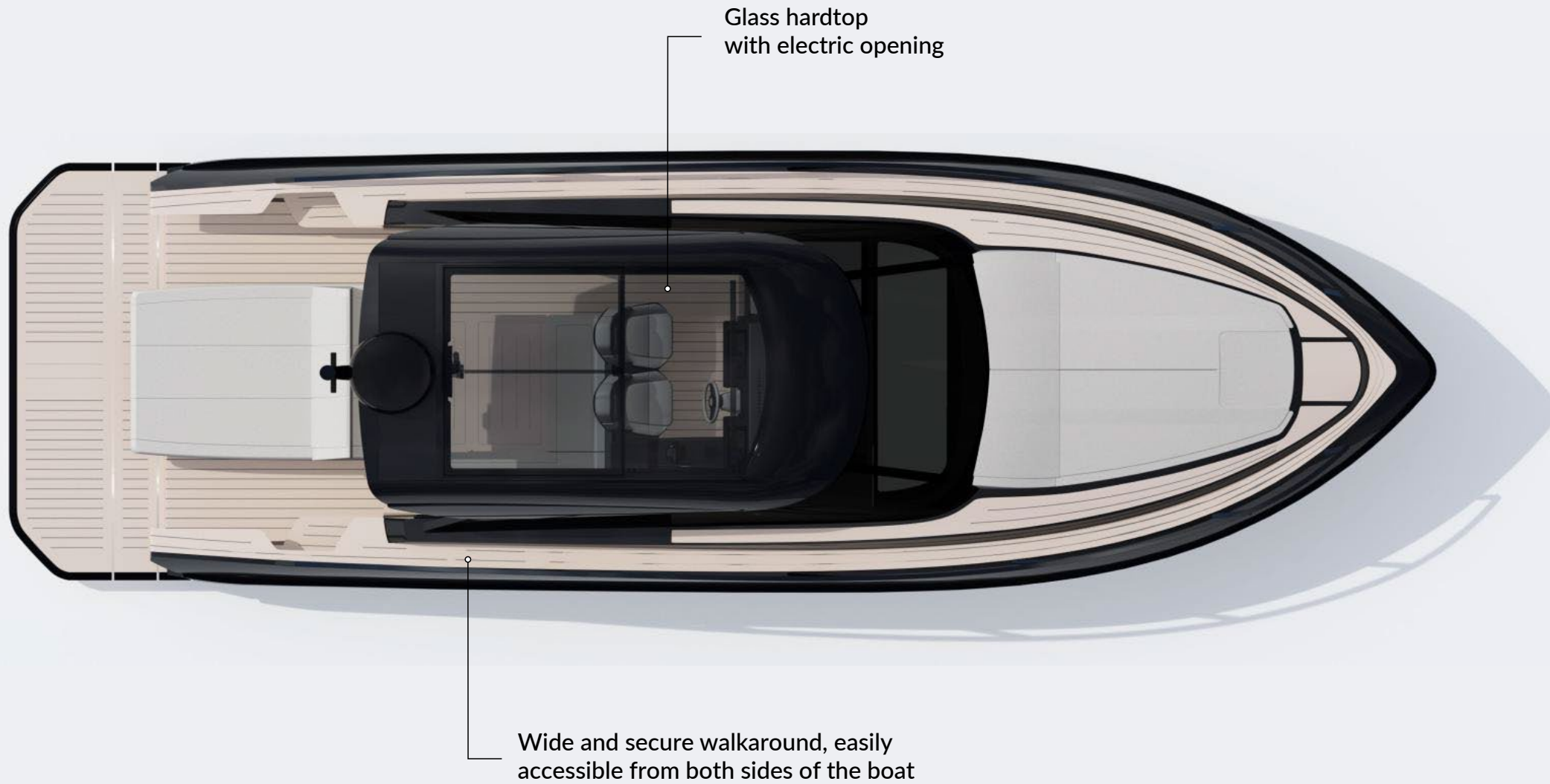

Glass hardtop  
with electric opening

Wide and secure walkaround, easily  
accessible from both sides of the boat





The large cockpit table can  
be expanded to a size of 3.4 ft x 3.9 ft



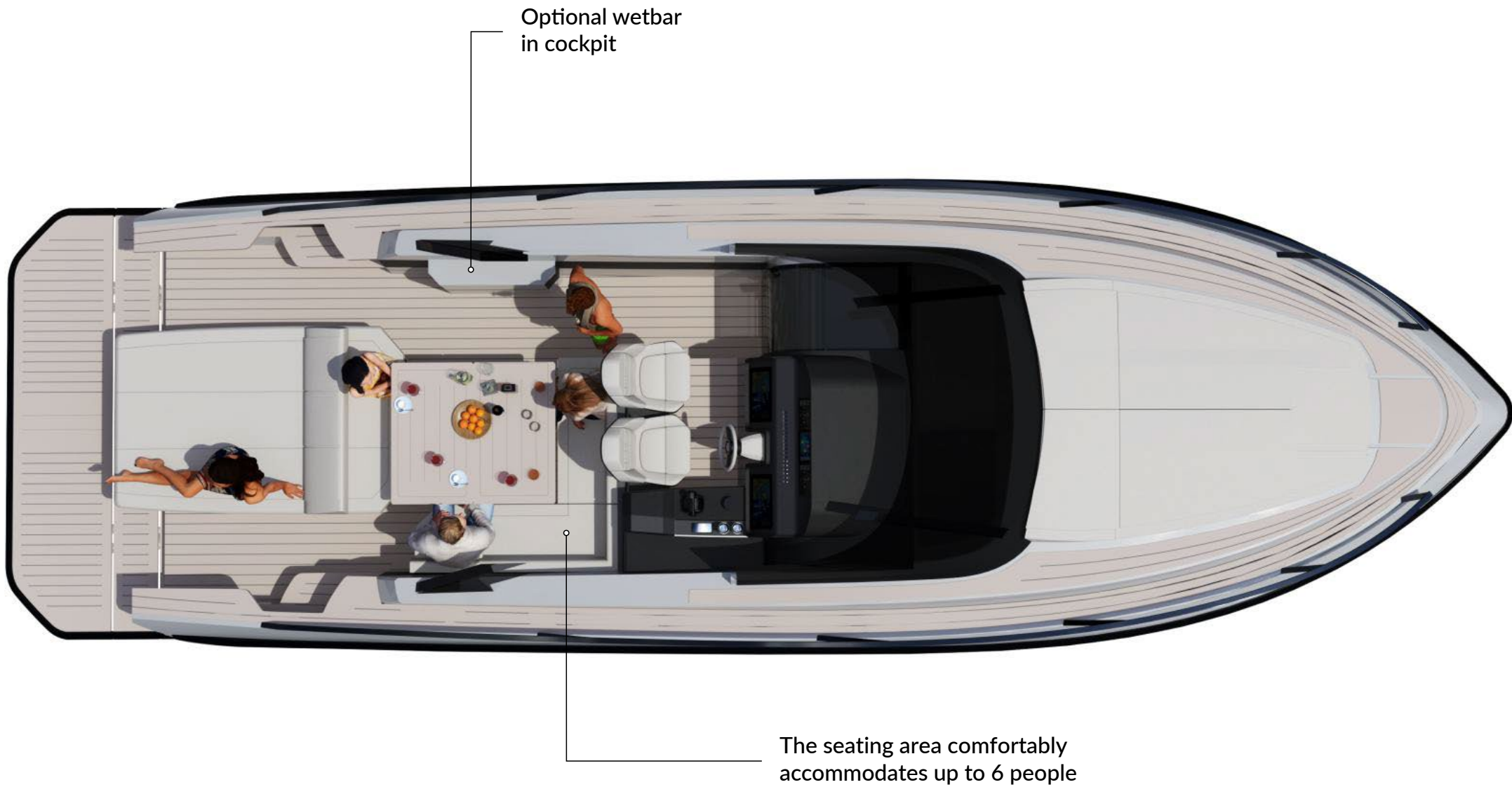

Optional wetbar  
in cockpit

The seating area comfortably  
accommodates up to 6 people





Protective rubber frame  
all around the boat



The transformer swim platform  
can be raised up to the level of the sunbed,  
or lowered down into the water.

Max. lift distance: 20 in  
Max. drop distance: 24 in  
Max. weight: 661 lb

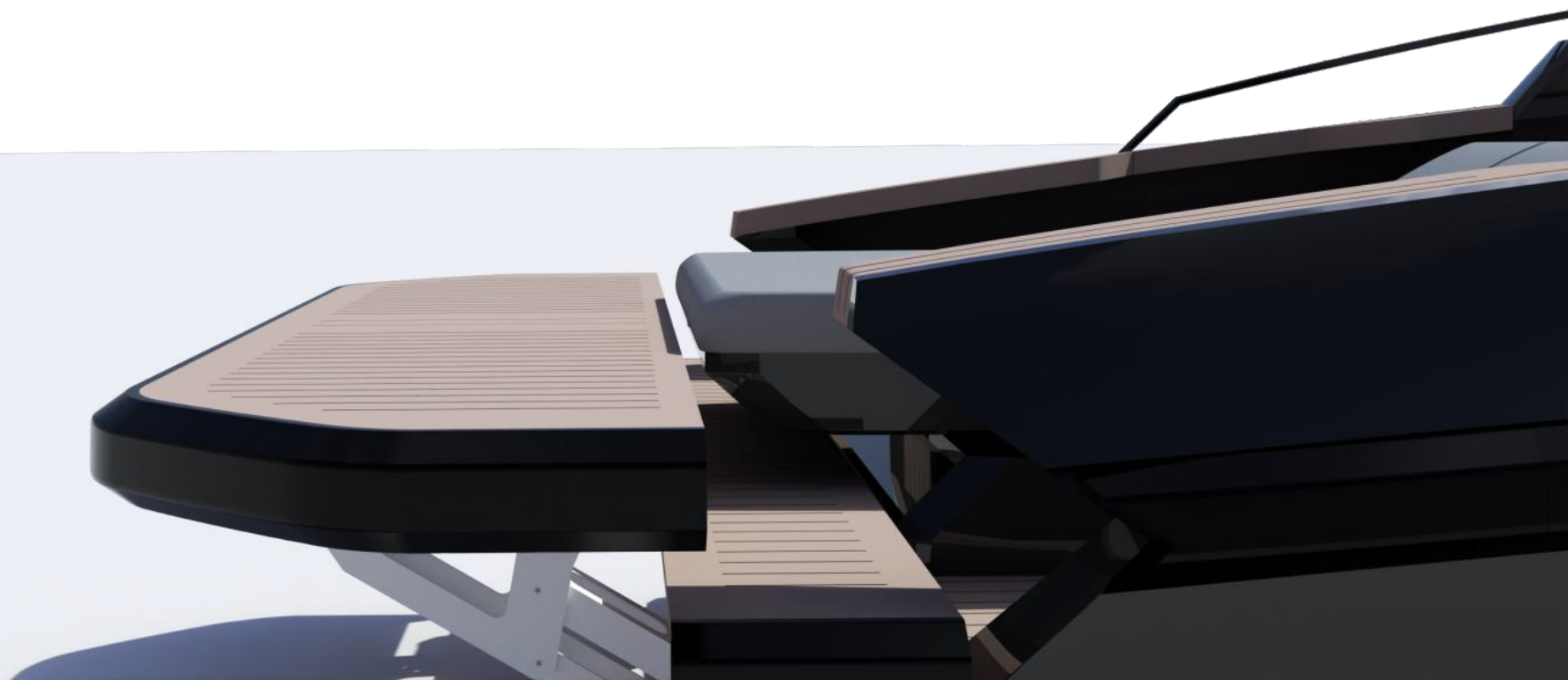



FOCUS 3X

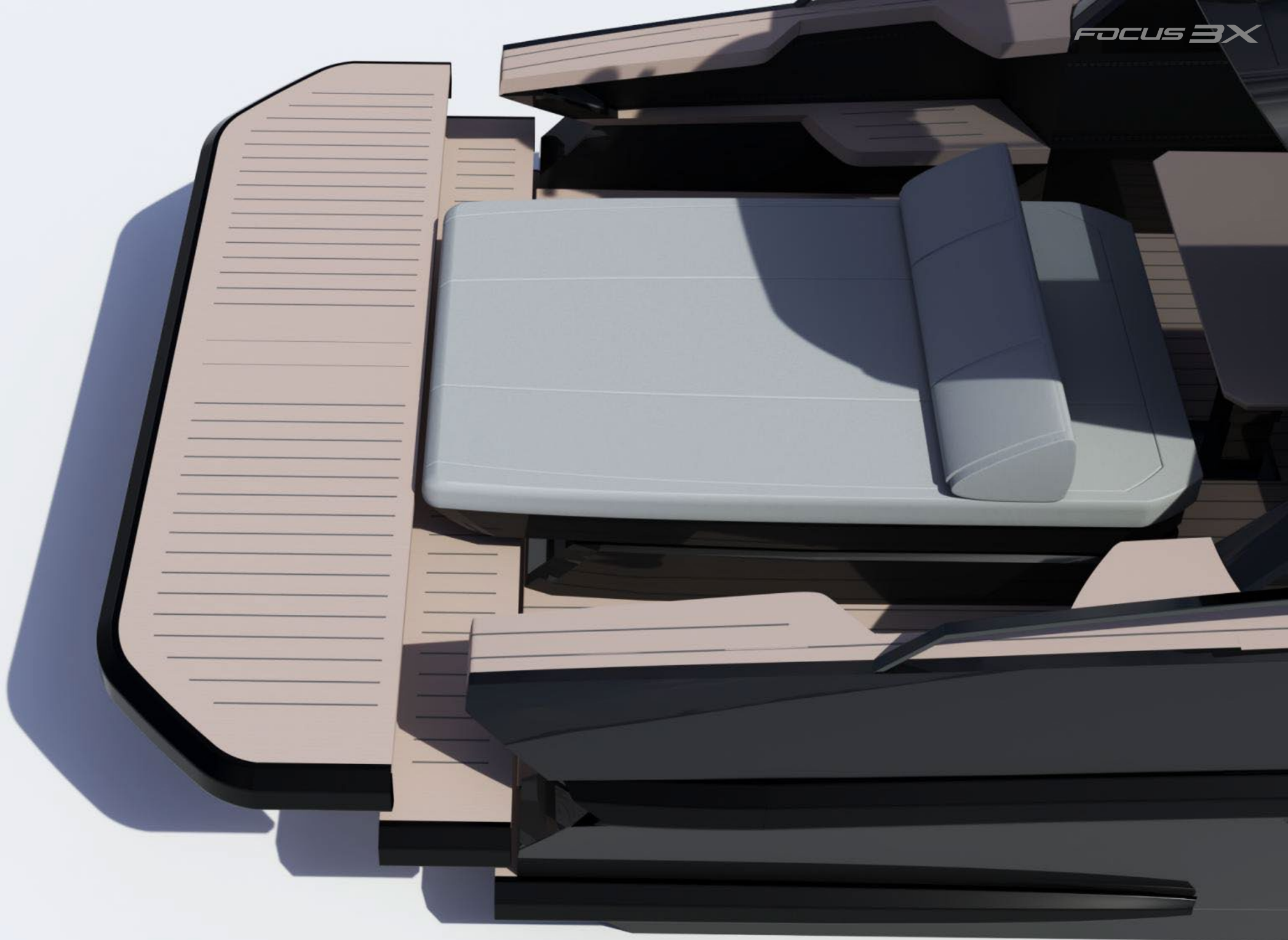

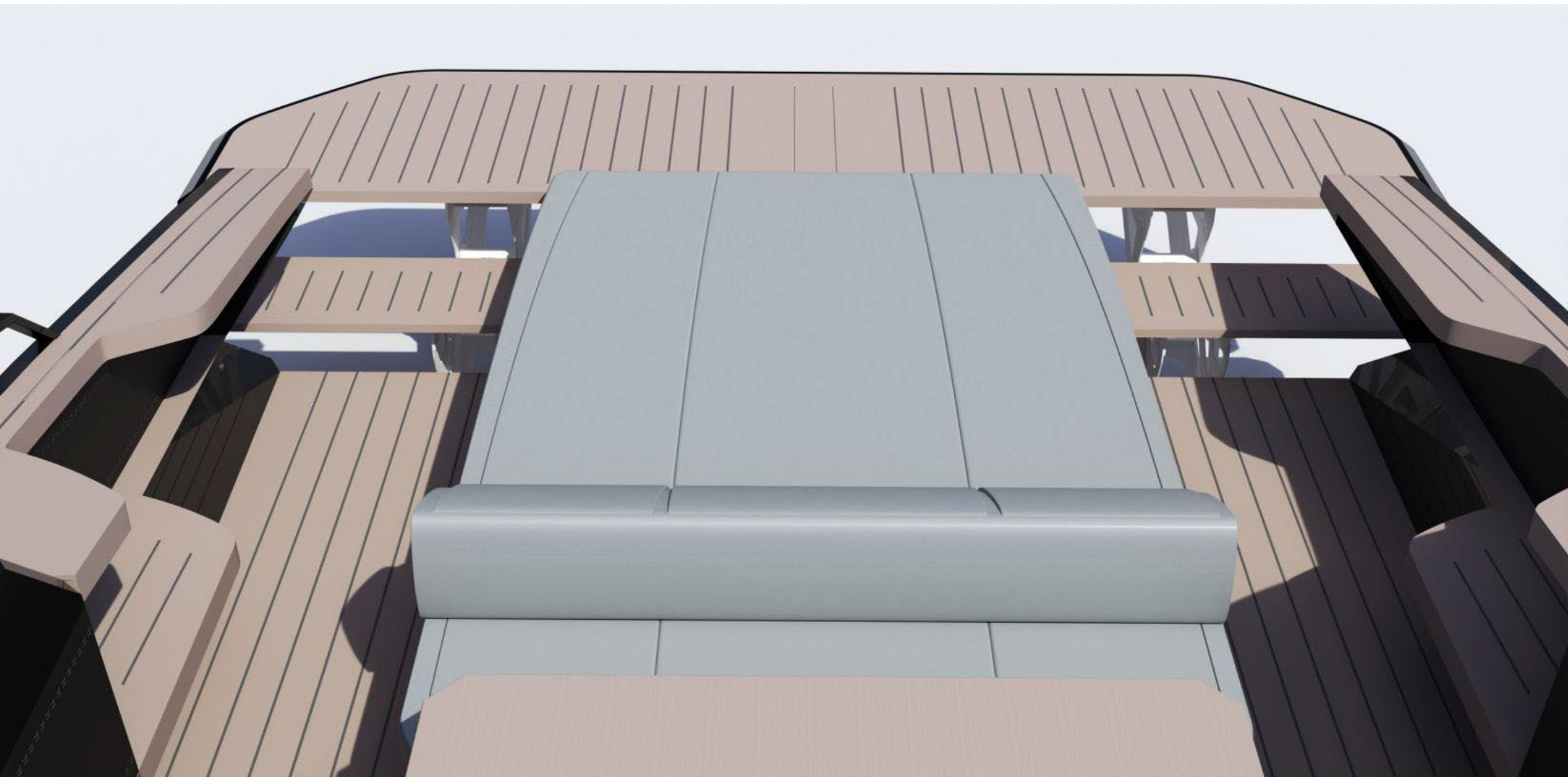



A hidden cleat with a hole for the rope keeps the boat's deck clean and uncluttered when the boat is tied



A defining feature of the boat are the large, two-meter (6.5 ft) wide, electric side windows in cockpit

Together with an opened electric glass hardtop this enables you to transform the boat into an almost completely open day-cruiser





The sunbed at the front is integrated into the bow, creating a sleek side silhouette. This also adds to its stability in strong winds



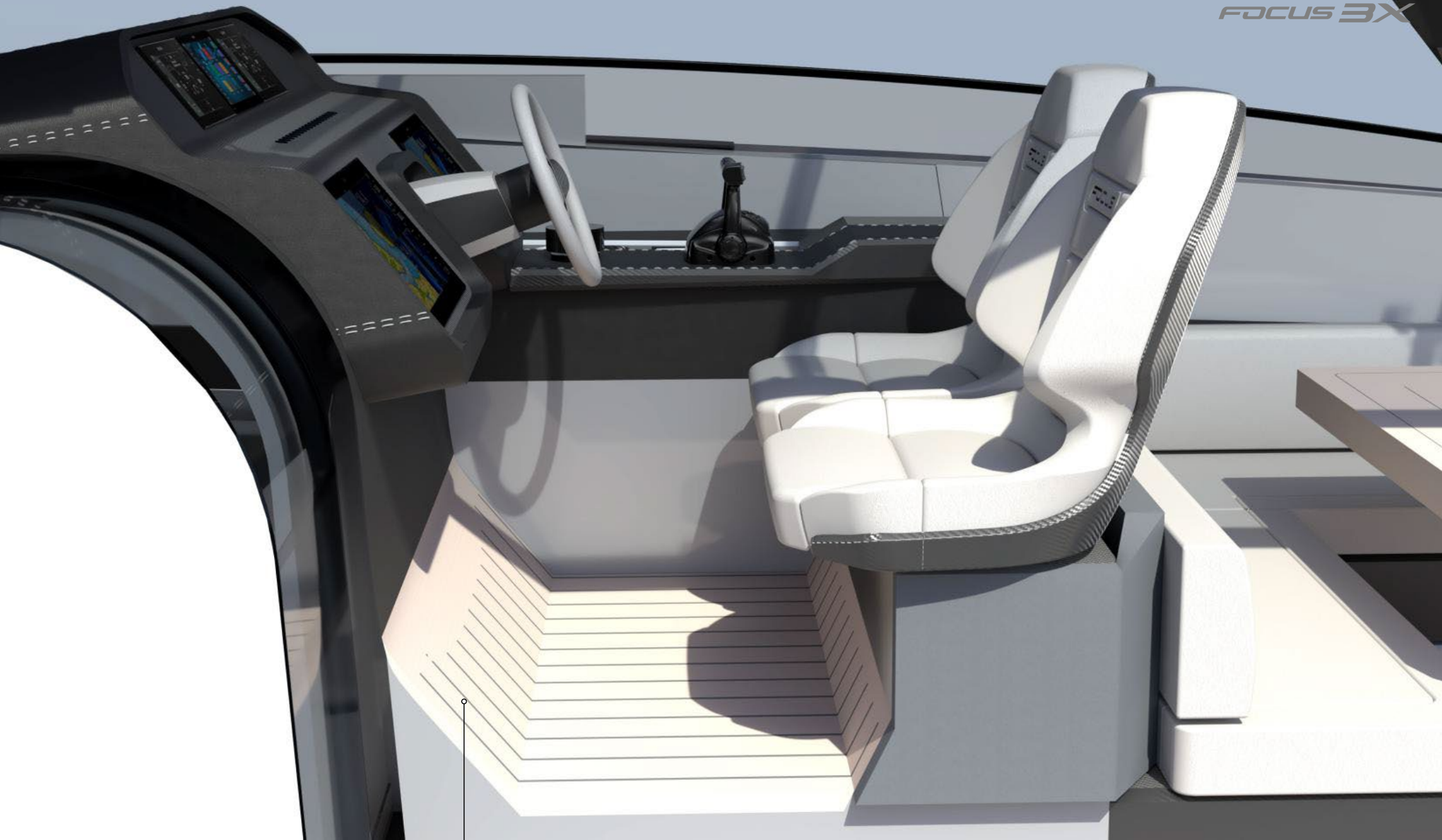

Ample legroom in the pilot area guarantees comfort, while either standing or seating









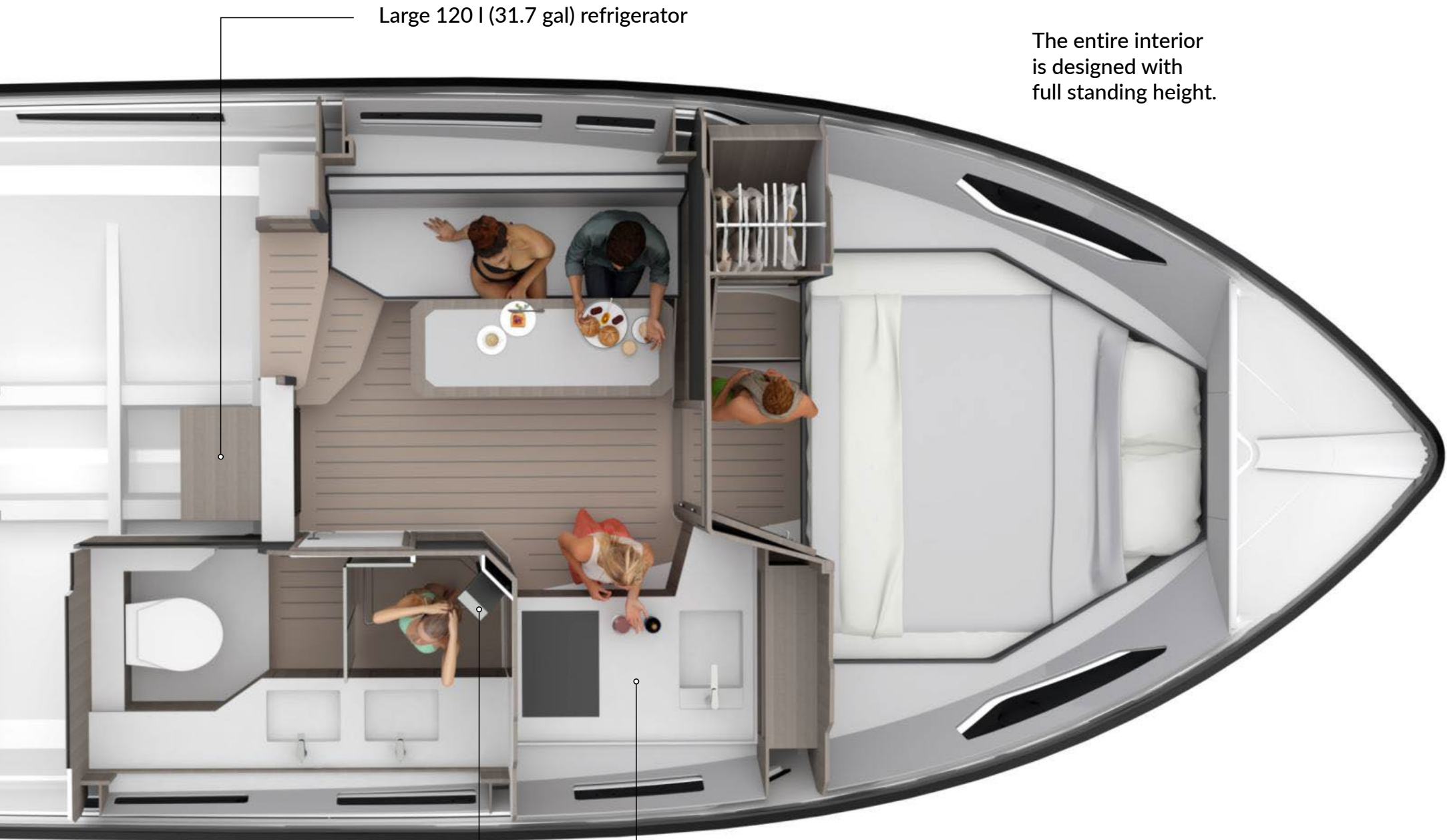

Large 120 l (31.7 gal) refrigerator

The entire interior is designed with full standing height.

Overhead shower

The galley offers generous space, complemented by extensive storage areas

The bathroom, impressively spacious for a boat of this size, boasts an overhead shower with standing height, two sinks, and plenty of room.



A dimmed glass door provides the option to discreetly separate the shower area



The saloon seating area can be quickly and effortlessly transformed into a 3.9 x 5.9 ft bed.

This is done by placing the backrest on the table, which is then lowered to create the sleeping surface.

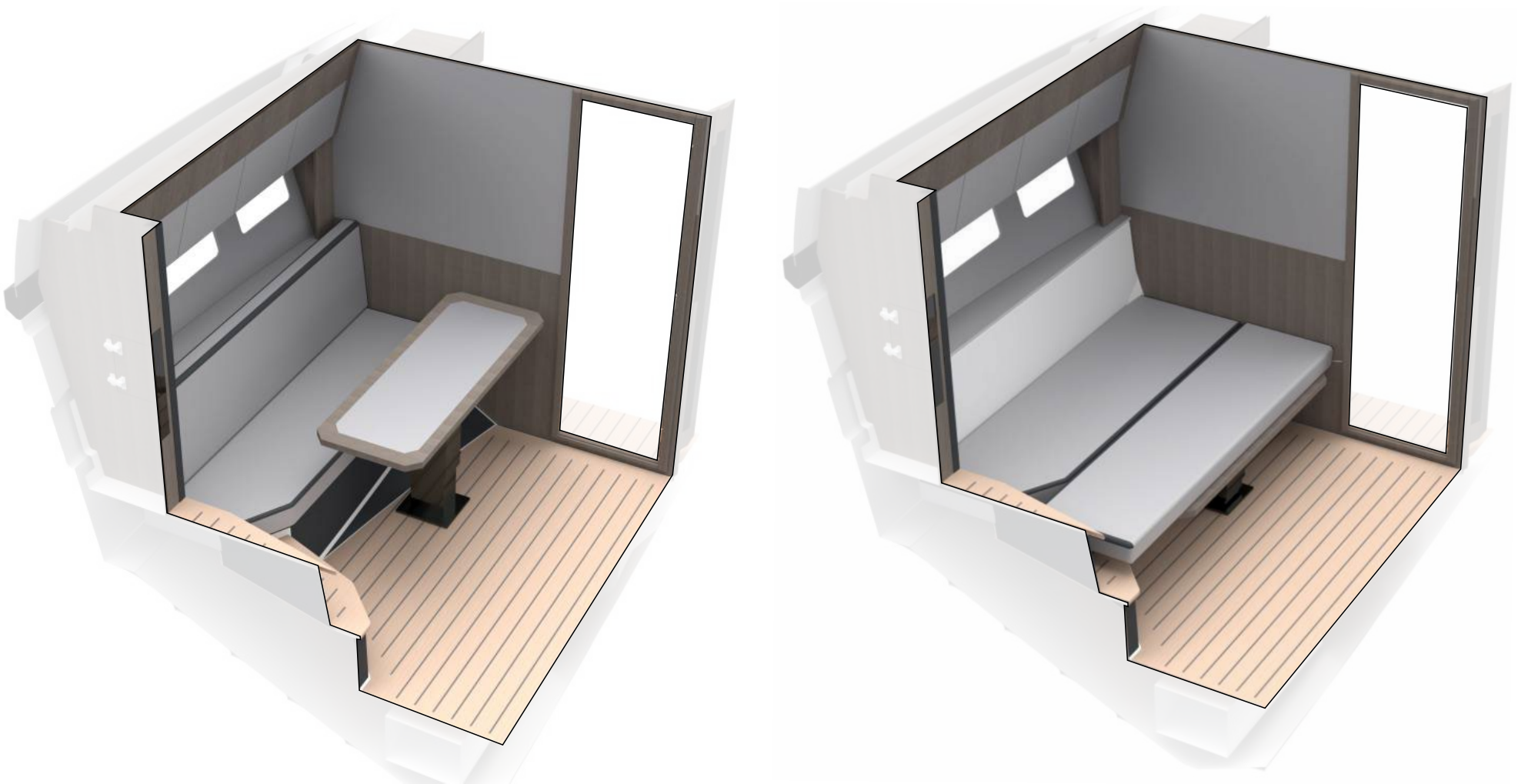

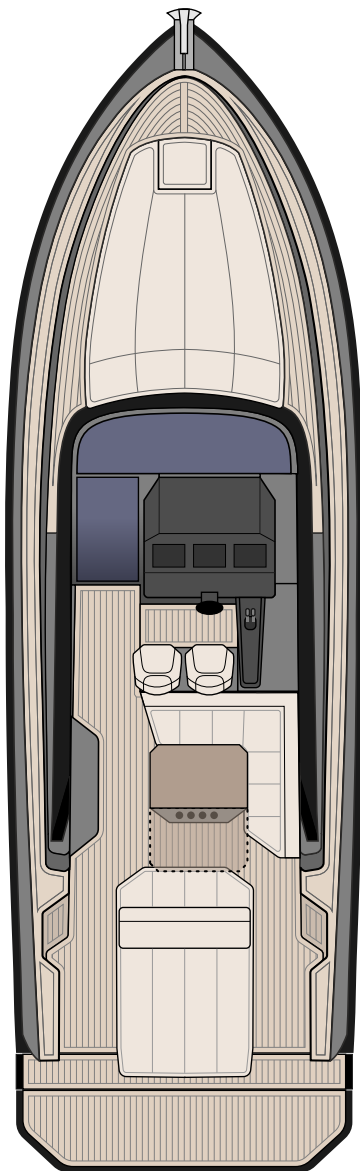

Cockpit Layout  
**V1**

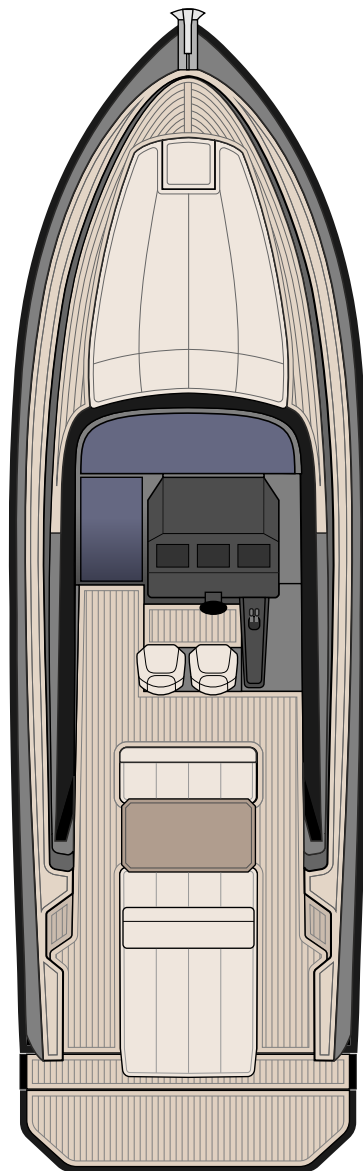

Cockpit Layout  
**V2**

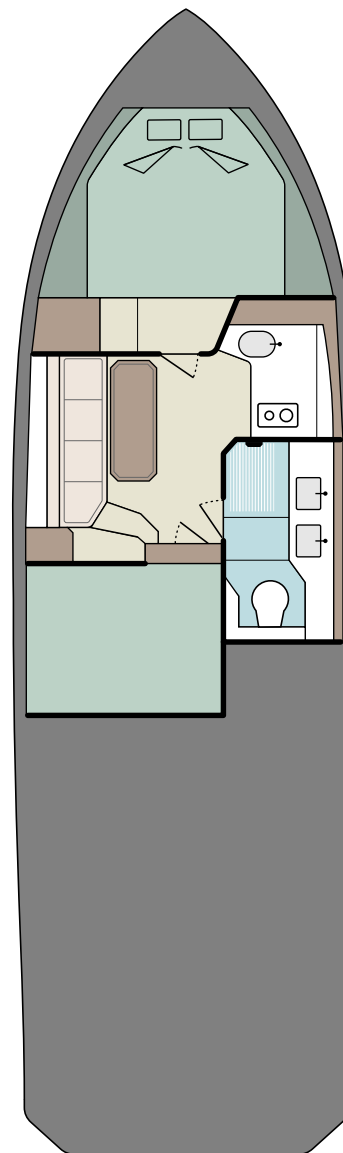

Interior Layout  
**2 Cabin**

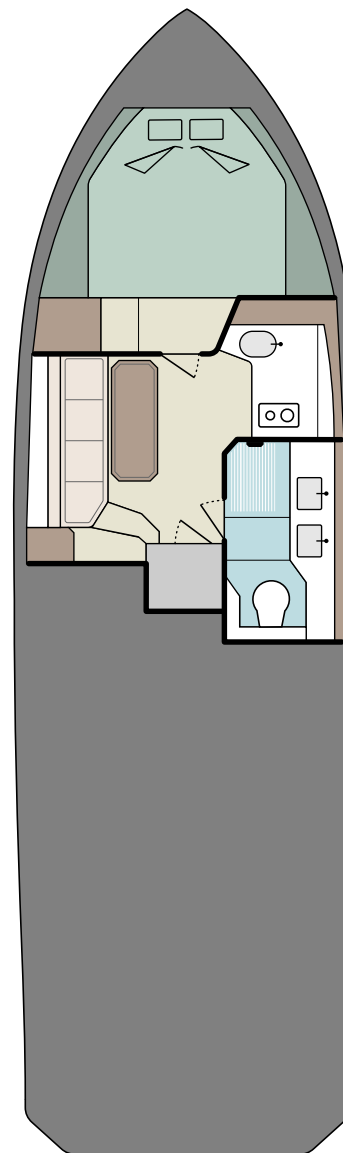

Interior Layout  
**1 Cabin**



**TECHNICAL DATA:**

Length overall:	38.2 ft
Beam overall:	11.8 ft
Dry weight:	14,330 lb
Fuel capacity:	211 gal
Fresh water capacity:	52 gal
Maximum Speed:	50 kn
Passengers:	10
Cabins:	1 or 2
Berths:	2 or 4 + 2 in saloon

Declaration of Conformity:	CE
Design Category:	B
Certification:	IMCI

## ENGINES:

**2x Yanmar 8LV370Z ZT, E-SHIFT (2x 370 HP)**

Rated Output	272 kW / 370 mhp
Rated Speed	3800 rpm
Displacement	1.7 gal / 272 cu. in
No. of cylinders	8 cylinders
Aspiration	Twin Turbocharged & Intercooled
Alternator	12V - 180A
Dry weight	959 lb
Estimated max. speed:	45 kn
Fuel tank:	211 gal
Warranty:	1000 engine hours







# FOCUS

MOTOR YACHTS

USA Contact:

**YachtCreators**

2890 Marina Mile Road, Suite 103  
Fort Lauderdale, FL 33312  
+1 (954) 650 7353

[hello@yachtcreators.com](mailto:hello@yachtcreators.com)



[@yachtcreators](#) [#dreambuildplay](#)